



**Oldham**  
Council

## **Delegated Decision**

# **Adoption of Highways – Development at Joshua Lane, Chadderton – Hercules Green**

Report of: Deputy Chief Executive – People and Place

Officer contact: Alison Dolan Senior Technical Admin.  
Ext. 4333

**8 March 2021**

### **Reason for Decision**

To obtain approval for the adoption of highways as Highway Authority and to identify the likely associated revenue costs to the Council.

### **Executive Summary**

The schedule lists the highways to become adopted as maintainable at the public expense.

### **Recommendation**

It is recommended that the highways listed in Schedule 1 of this report be adopted as highways maintainable at public expense.

---

## **Adoption of Highways – Development at Joshua Lane, Chadderton – Hercules Green**

### **1 Background**

1.1 This report is the conclusion of the process by which a private developer constructs highways for maintenance at the public expense for the benefit of the development.

### **2 Current Position**

2.1 The highways in Schedules 1 and 2, described below and indicated on the attached location plans, have been constructed in accordance with the approved specification for highways to be adopted.

### **3 Schedule 1**

#### 3.1 Development at Joshua Lane, Chadderton

Hercules Green	From its junction with the Oldham Borough boundary at Joshua Lane and continuing for a distance of 50 metres in a generally east south easterly direction to its cul-de-sac end with associated turning heads of 9.5 and 11 metres respectively. Area = 670.5m <sup>2</sup>
----------------	--

### **4 Actions Proposed**

4.1 The following action is proposed:

to adopt, on behalf of the Council as Highway Authority, the highways specified in Schedule 1 above as highways maintainable at public expense, effective immediately

### **5 Options/Alternatives**

5.1 Option 1: To approve the recommendation.

5.2 Option 2: Not to approve the recommendation.

### **6 Preferred Option**

6.1 The preferred option to approve is Option 1.

## 7 Financial Implications

### Revenue Implications

7.1 This proposal will increase annual running costs by £727 analysed as follows:

Item	Annual Cost		Funded from Cost Centre
	Sub Total £	Total £	
1. Adopting 670.5 sq m of Highway @ £0.70/sq m		469	Highways Operations
2. Maintain 3 Lighting columns/signs etc	157		Street Lighting
3. Energy costs of 2. above	100		Corporate Landlord then recharged to Street Lighting
Sub Total Lighting		257	
Total All		727	

7.2 If there are in year budget pressures within the above areas, the Directorate will have to manage its resources to ensure that there is no adverse variance at the year end.

### Capital Implications

7.3 There are no capital implications contained within this proposal.

(Nigel Howard)

## 8 Legal Services Comments

8.1 None. (A Evans)

## 9 Co-operative Agenda

9.1 There are no Co-operative issues or opportunities arising and the proposals are in line with the Council's Ethical Framework.

## 10 Human Resources Comments

10.1 None

## 11 Risk Assessments

11.1 None

12 **IT Implications**

12.1 None.

13 **Property Implications**

13.1 None.

14 **Procurement Implications**

14.1 None

15 **Environmental and Health & Safety Implications**

15.1 In adopting the highway, the Local Authority is taking on responsibility for maintaining it in a safe condition.

16 **Equality, community cohesion and crime implications**

16.1 By adopting this highway, public rights of access will be safeguarded.

17 **Equality Impact Assessment Completed?**

17.1 No

18 **Key Decision**

18.1 No.

18 **Key Decision Reference**

18.1 Not applicable.

19 **Background Papers**

19.1 The following is a list of background papers on which this report is based in accordance with the requirements of Section 100(1) of the Local Government Act 1972. It does not include documents which would disclose exempt or confidential information as defined by the Act :

None.

**APPROVAL**

**Decision maker**



Signed \_\_\_\_\_  
Cabinet Member,  
Neighbourhoods and Culture

Dated 22<sup>nd</sup> March 2021

**In consultation with**



Signed \_\_\_\_\_  
Director of Environmental  
Services

Dated: 10 March 2021

LOCATION PLAN - ADOPTABLE HIGHWAY SHADED PINK

Creator: AD

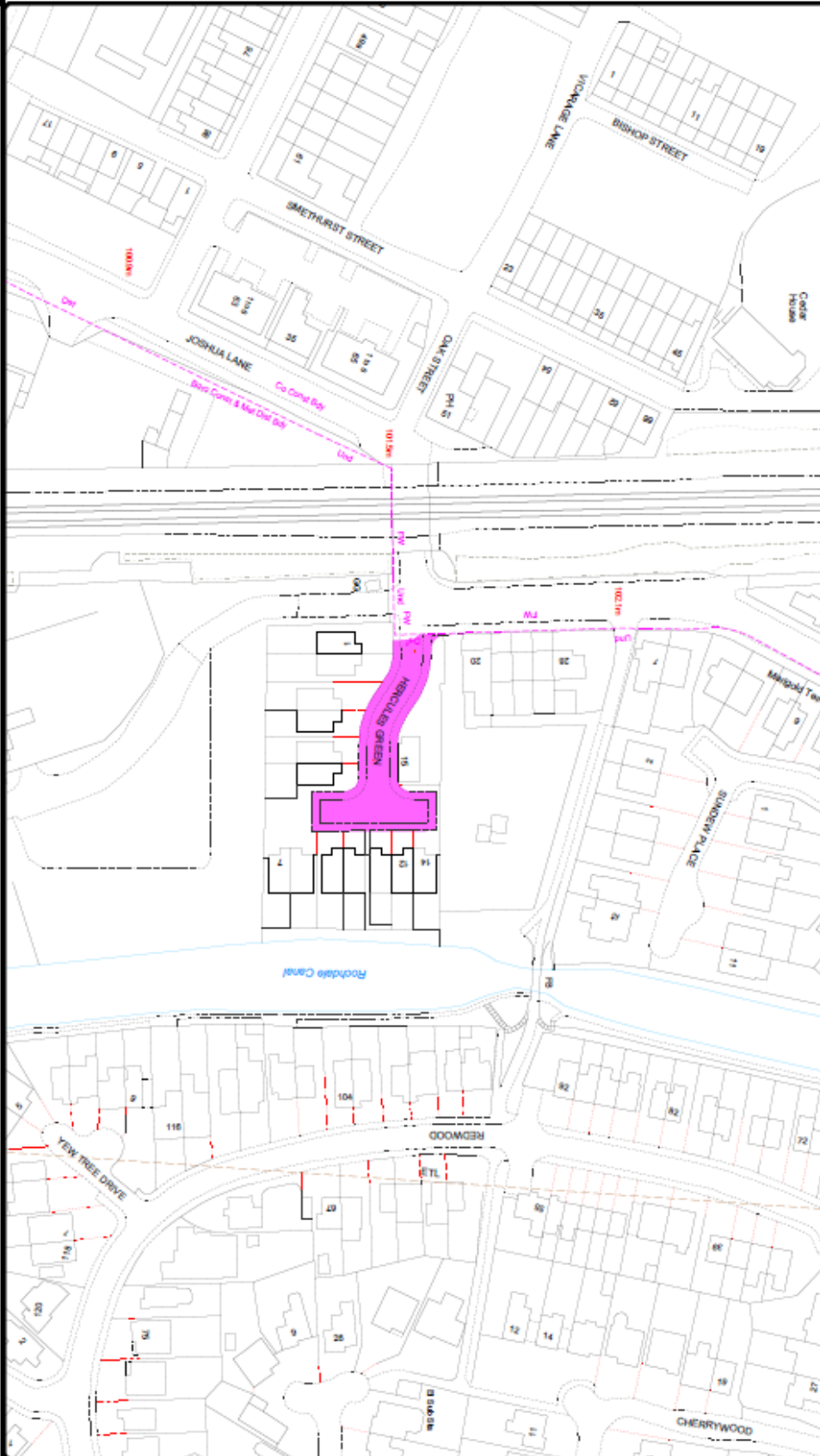

Production Date: 17<sup>th</sup> February 2021  
Scale 1:1250 when printed at A4

© Crown copyright and database rights 2019  
Ordnance Survey licence 0100019668

North arrow pointing up.

Oldham Council logo.